

**AGREEMENT
AMONG THE DEPARTMENT OF DEFENSE,
THE DEPARTMENT OF THE AIR FORCE,
AND
SPRINGFIELD WIND FARM LLC,
ADDRESSING THE SPRINGFIELD WIND PROJECT
NEAR SPRINGFIELD, COLORADO**

This is an agreement among the Department of Defense (DoD), acting through the Military Aviation and Installation Assurance Siting Clearinghouse; the Department of the Air Force (MILDEP), acting through the Deputy Assistant Secretary of the Air Force for Installations (collectively, the “DoD parties”); and Springfield Wind Farm LLC (Project Owner). Together, these three entities are referred to as “parties” and individually as a “party.” Any reference to “DoD parties” means both parties and does not indicate that one party acts for or on behalf of the other. In this agreement, DoD does not include the United States Army Corps of Engineers when engaged in its civil works program, including any permitting actions.

This agreement is entered into pursuant to section 183a of title 10, United States Code, and part 211 of title 32, Code of Federal Regulations (CFR).

Attachments A, *Federal Aviation Administration Filings for Springfield Wind Project*; B, *Springfield Wind Turbines and Project Area*; and C, *Springfield Wind Project Area Coordinates*, are attached to this agreement and made a part hereof.

For good and valuable consideration, the receipt of which is hereby acknowledged, the parties agree as follows:

SECTION 1. PURPOSE.

A. Objective. The objective of this agreement is to mitigate any potential adverse impact and to minimize risks to national security while allowing the Springfield Wind Project (Project) to proceed with development.

B. De-confliction. As the Project was originally filed, it would conflict with DoD’s low-level training operations in a portion of Military Training Route IR-409 used for F-16 pilot training from Buckley Air National Guard Base (Installation). The parties have focused on de-conflicting these activities and agree that the terms below will allow the mutual goals of the parties to be met.

SECTION 2. DEFINITIONS.

A. Access. “Access” means either to enter a physical space or to remotely read, copy, edit, divert, release, alter the state of, or otherwise affect information technology systems (e.g., network, data, security, software, hardware).

B. Actual Curtailment Hours. [RESERVED]

C. ASN. Federal Aviation Administration Aeronautical Study Number.

D. Banked Hours. [RESERVED]

E. CFIUS. Committee on Foreign Investment in the United States.

F. CFR. Code of Federal Regulations.

G. Curtailment. [RESERVED]

H. Day. A calendar day, unless indicated otherwise.

I. DoD. The Department of Defense, an executive department of the United States.

J. FAA. Federal Aviation Administration, an agency of the United States Department of Transportation.

K. Fiscal Year. [RESERVED]

L. Hour. [RESERVED]

M. MILDEP. The Department of the Air Force, a military department of the United States.

N. National Security or Defense Purpose. [RESERVED]

O. Project. The Springfield Wind Project, which will consist of no more than 280 of the proposed wind turbines and five (5) meteorological (MET) towers identified on Attachment A by ASN or by substitute ASNs submitted in accordance with section 3.C.2 of this agreement.

P. Project Owner. Springfield Wind Farm LLC, and its successors and assigns.

Q. Siting Clearinghouse. The Military Aviation and Installation Assurance Siting Clearinghouse established pursuant to 10 U.S.C. section 183a.

R. U.S.C. United States Code.

SECTION 3. MITIGATION.

A. In General. This agreement is structured to ensure Project Owner may construct and operate the Project without adversely impacting DoD military operations and readiness. Project Owner agrees to limit the total number of Project wind turbines to no more than 280 with a maximum height of 660 feet above ground level (AGL) and Project MET towers to no more than five (5) with a maximum height of 660 feet AGL for each MET tower. Project Owner agrees to restrict the construction of the Project wind turbines and MET towers to the designated Project Area, as shown in Attachment B. The specific geographic coordinates outlining the designated Project Area are provided in Attachment C. Project Owner agrees to install Night Vision Goggle compatible lighting on all turbines and MET towers associated with the Project that are required by the FAA to have lighting.

B. Amendment of Applications. [RESERVED]

C. Withdrawal of Objections.

1. The wind turbines listed in Attachment A have received Determinations of No Hazard from the FAA. Project Owner may apply to the FAA for up to five (5) additional ASNs for MET towers within 24 months of the execution of this agreement. The DoD parties shall deliver to the FAA “No Objections with Provisions” for the ASNs corresponding to those MET towers, *provided* that the total number of MET towers does not exceed five (5), that the proposed height of those MET towers does not exceed 660 feet AGL, that the MET tower ASNs are located within the siting parameters of the Project Area specified in Attachment B of this agreement or any amendments to this agreement, and that this agreement is incorporated into the MET tower ASN filings. The “Provisions” will incorporate by reference this agreement, referring to it by its title, the date executed, and its signatories.

2. If Project Owner submits any substitute ASNs to FAA within 24 months of the execution of this agreement, the DoD parties agree to deliver to the FAA “No Objections with Provisions” to those substitute ASNs, provided that the substitute ASNs do not exceed the maximum height specified in Section 3.A, that the substitute ASNs are located within the siting parameters of the Project Area specified in Attachment B of this agreement or any amendments to this agreement, that the total number of ASNs after substitution does not exceed 280 wind turbines and five (5) MET towers, and that this agreement is incorporated into the substitute ASN filings.

3. All parties agree that if Project Owner requests to extend the effective period of FAA’s Determination of No Hazard to Air Navigation in accordance with 14 CFR section 77.35, then the DoD Parties agree to deliver to the FAA “No Objections with Provisions” provided that the affected ASNs are listed on Attachment A or are substitute ASNs that were submitted within 24 months of the execution of this agreement, that the ASNs do not exceed the maximum height specified in Section 3.A and are located within the siting parameters of the Project area specified in Attachment B of this agreement or any amendments to this agreement, that the total number of ASNs for the Project still do not exceed 280 wind

turbines and five (5) MET towers, and that this agreement is incorporated into the ASN filings affected by the extension.

4. The DoD parties agree not to object to the construction and operation of the Project before any federal, state, or local regulatory entity with jurisdiction over the Project (except as provided in sections 6.B and 10.H of this agreement), provided that Project Owner is in material compliance with the terms of this agreement and that Project Owner has disclosed to the DoD parties in writing all material facts necessary to fully assess potential adverse impacts and all material facts relevant to other federal, state, or local regulatory entity jurisdictional matters.

D. Other Regulatory Actions. This agreement shall not prevent or limit the DoD parties from communicating in any form with any regulatory body or agency with jurisdiction or possible jurisdiction over matters affecting the Installation beyond the Project.

SECTION 4. CURTAILMENT.

[RESERVED]

SECTION 5. REVIEW OF BUSINESS ENTITIES.

A. Protection of Defense Capabilities. It is a priority for the MILDEP to protect national defense capabilities and military operations, including military installations, research, development, test and evaluation activities, and military readiness activities, from compromise and exploitation that may occur due to an activity under foreign control operating in the vicinity of those national defense capabilities and military operations.

B. Advance Notice.

1. Project Owner shall provide advance written notice to the MILDEP of the following:

a. The names of business entities or persons having a direct ownership interest in the Project.

b. The names of the material vendors and business entities with which Project Owner will potentially execute contracts to perform construction, supply turbines, or conduct operations activities at the location of the Project.

c. The names of any foreign entities or persons being allowed to access the wind turbine structures and associated data systems.

2. For those entities or persons identified under paragraphs 5.B.1.a and 5.B.1.b, the MILDEP agrees to identify to Project Owner, no later than 30 days after the effective date of

this agreement, any entity or person posing a security concern. For those entities or persons identified under paragraph 5.B.1.c, the MILDEP agrees to identify to Project Owner, no later than 30 days after the receipt of the name of any foreign entity or person being allowed to access the wind turbines and associated data systems, any entity or person posing a security concern. Project Owner agrees to enter into negotiations with the DoD parties in order to mitigate any such concern. Any such security concern must be resolved prior to allowing access to the site by such persons or representatives of such entities or the use of wind turbines or other permanent on-site equipment manufactured by such a business entity.

3. Project Owner agrees to provide advance written notice to the MILDEP of Project Owner's use of any material vendor not previously screened pursuant to this section. The term "material" used in this subsection means "significant, influential, or relevant." Project Owner shall allow the MILDEP 30 days following such a notice to conduct a security review and assess any security concern. Project Owner will provide advance written notice of a potential new material vendor but need not wait 30 days if an unexpected situation arises for which employing services or vendors immediately is prudent for the operation of the Project.

SECTION 6. ASSIGNMENT.

A. Right to Assign. This agreement shall be binding upon Project Owner and its successors and assigns. If Project Owner and its successors or assigns (assignors) elect to sell, convey, mortgage, assign, or otherwise transfer all or any part of its interests and obligations in the assets comprising the Project (assignment) to any third party (assignee), assignor shall cause such assignee to expressly acknowledge the existence of this agreement. The assignor shall provide a copy of this agreement to the assignee. The assignee shall provide new point of contact information (as in Section 8) to the DoD parties.

B. Notice of Assignment to CFIUS. If the prospective assignee is a foreign national or foreign-owned or -controlled business entity, assignor and the proposed assignee shall jointly provide notice of the proposed transaction to CFIUS in accordance with applicable regulations (subpart D of 31 CFR part 800) and provide a copy of the notice to the MILDEP. Nothing in this agreement shall prohibit or limit DoD from objecting to the transaction before CFIUS, nor limit communications with CFIUS during national security reviews and investigations, and, should mitigation result, during mitigation, tracking, and post-consummation monitoring and enforcement, pursuant to applicable statutes and regulations.

C. Effect of Assignment. Upon an assignment, assignor shall be relieved of any obligations or liabilities under this agreement to the extent that the assignee has assumed in writing such obligations or liabilities and provided that Project Owner has provided a copy of the assignment, including the assumption of obligations and liabilities, to the DoD parties.

SECTION 7. EFFECTIVE DATE AND EXPIRATION.

A. Effective Date. This agreement becomes effective on the date when all parties have signed it.

B. Expiration. This agreement shall expire and have no further force and effect upon the occurrence of the earlier of the following:

1. Construction of the Project has not commenced within the time prescribed under 14 CFR sections 77.33 and 77.35.
2. The Project is decommissioned.
3. The DoD ceases to use Military Training Route IR-409 permanently and takes appropriate action with FAA accordingly.
4. Termination of the agreement by written mutual agreement of the parties.

C. Actions Prior to Expiration. Any activities engaged in by the parties that occurred prior to expiration of this agreement shall remain valid and continue in effect, notwithstanding the expiration of the agreement.

SECTION 8. POINTS OF CONTACT AND NOTIFICATION.

A. Points of Contact (POCs). The following persons shall be the primary POCs for the parties for purposes of this agreement. Any notice, request, or other communication to be provided pursuant to this agreement shall be delivered to the POCs. Any party may change its POC by providing written notification of the change to the other parties at least 30 days in advance of the change taking effect.

1. DoD. Executive Director, Military Aviation and Installation Assurance Siting Clearinghouse, 3400 Defense Pentagon, Room 5C646, Washington, DC 20301-3400
2. MILDEP. Director, Air Force Encroachment Management, Office of the Deputy Assistant Secretary of the Air Force, Installations, 1665 Air Force Pentagon, Suite 5E1000, Washington, DC 20330-1665, usaf.pentagon.saf-ie.mbx.saf-ieim-workflow@mail.mil
3. Project Owner. Vice President, Springfield Wind Farm LLC, c/o Orion Renewable Energy Group LLC, 155 Grand Ave., Suite 706, Oakland, CA, 94612, with a copy (not constituting notice) to: Springfield Wind Farm LLC, c/o Orion Renewable Energy Group LLC, Attn: General Counsel, 155 Grand Ave., Suite 706, Oakland, CA, 94612

B. Notification. Any written notice shall be sent by registered or certified mail, postage prepaid, sent by a nationally recognized overnight delivery service that provides a receipt for delivery, or hand delivered. A notice shall be deemed received when delivered to the recipient's address.

SECTION 9. BREACH AND DISPUTE RESOLUTION.

If a party believes that another party has breached this agreement, it shall provide written notice of the breach within 30 days of discovery of the breach to all other parties and provide the breaching party an opportunity to cure the breach. If there is a dispute between the involved parties as to whether a breach occurred, the involved parties agree to attempt to resolve the dispute beginning with Project Owner and representatives of the MILDEP at the Installation. Disputes may be elevated, on the part of the DoD parties, to the MILDEP headquarters and then to the Executive Director of the Siting Clearinghouse. If the breach is not cured or resolved after this initial dispute resolution process, any party may seek to enforce this agreement. Each party specifically reserves any and all rights or causes of action it may have either at law or in equity to require compliance with any provision of this agreement. Each party reserves the right to enforce or refrain from enforcing against another party the terms of this agreement as it sees fit and failure to enforce does not act to excuse future breaches.

SECTION 10. GENERAL PROVISIONS.

A. Amendments. Any party to this agreement may request that it be amended, whereupon the parties agree to consult to consider such amendments. Any amendment to this agreement shall become effective when signed by all of the parties unless its terms provide for a different effective date.

B. Integration. This agreement contains the entire agreement and understanding between the parties with respect to all of the subject matter contained herein, thereby merging and superseding all prior agreements and representations by the parties with respect to such subject matter.

C. Governing Law. This agreement shall be governed by and construed in accordance with the laws of the United States and the State of Colorado, as may be applicable.

D. Interpretation. In the event an ambiguity or question of intent or interpretation arises, this agreement shall be construed as if drafted jointly by the parties and no presumption or burden of proof shall arise favoring or disfavoring any party by virtue of authorship of any of the provisions of this agreement. Any reference to any Federal, state, interstate, local, or foreign statute or law shall be deemed also to refer to all rules and regulations promulgated thereunder, as they may have been amended from time to time, unless the context requires otherwise.

E. Headings and Titles. The headings or section titles contained in this agreement are inserted solely for convenience and do not constitute a part of this agreement between the parties, nor should they be used to aid in any manner in the construction of this agreement.

F. Severability. If any term, provision, or condition of this agreement is held to be invalid, void, or unenforceable by a U.S. Government authority and such holding is not or cannot be appealed further, then such invalid, void, or unenforceable term, provision, or condition shall be

deemed severed from this agreement and all remaining terms, provisions, and conditions of this agreement shall continue in full force and effect. The parties shall endeavor in good faith to replace such invalid, void, or unenforceable term, provision, or condition with valid and enforceable terms, provisions, or conditions that achieve the purpose intended by the parties to the greatest extent permitted by law.

G. Waivers; Remedies Cumulative. There is no implied waiver of rights under this agreement. No failure or delay on the part of a party in exercising any of its rights under this agreement or in insisting upon strict performance of provisions of this agreement, no partial exercise by either party of any of its rights under this agreement, and no course of dealing between the parties shall constitute a waiver of the rights of any party under this agreement, other than the requirement to raise a matter of breach within 30 days of discovery. Any waiver shall be effective only by a written instrument signed by the party granting such waiver, and such waiver shall not operate as a waiver of, or estoppel with respect to, any subsequent failure to comply with this agreement. The remedies provided in this agreement are cumulative and not exclusive of any remedies provided by law.

H. CFIUS. Nothing in this agreement shall relieve Project Owner or its successors or assigns from complying with 31 CFR part 800 (Mergers, Acquisitions, and Takeovers by Foreign Persons) nor prevent or limit the parties from communicating in any form with CFIUS.

I. Anti-Deficiency. For the DoD parties, this agreement is subject to the availability of appropriated funds and sufficient resources. No provision in this agreement shall be interpreted to require obligation or payment of funds in violation of the Anti-Deficiency Act, 31 U.S.C. section 1341.

J. Disclosure. The parties may freely disclose this agreement with any person or entity. DoD will post the agreement on the Siting Clearinghouse website. Project Owner may mark that part of any document it believes to be proprietary or competition sensitive and that it wants DoD or the MILDEP to exempt from disclosure. The DoD parties will only disclose any such marked information in accordance with the provisions of 5 U.S.C. section 552 (the Freedom of Information Act).

K. No Third Party Beneficiaries. Nothing in this agreement, express or implied, is intended to give to, or shall be construed to confer upon, any person not a party any remedy or claim under or by reason of this agreement. This agreement shall be for the sole and exclusive benefit of the parties and their respective successors and assigns.

L. Full and Complete Satisfaction. The completion of the obligations of each of the parties under this agreement constitute the full and complete satisfaction of those obligations.

M. Other Federal Agencies. This agreement does not bind any Federal agency, other than the DoD parties, nor waive required compliance with any law or regulation.

N. Completion of Construction. Within 60 days of the completion of construction of the Project, Project Owner shall deliver to DoD copies of the FAA form 7460-2 for each ASN, including the final coordinates for each turbine erected.

O. Grid Operator Protocols. [RESERVED]

P. Signature/Counterparts. The parties represent and warrant that the signatories below have authority to sign on behalf of and bind each respective party, and that no other signature is required to bind that party. This agreement may be executed in several counterparts, each of which shall be deemed an original, all of which shall constitute but one and the same instrument.

IN WITNESS WHEREOF, the parties have executed and delivered this agreement.

FOR THE DEPARTMENT OF DEFENSE:

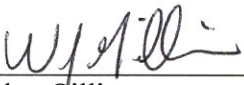

Jordan Gillis
Assistant Secretary of Defense
(Sustainment)

15 OCT 2020

Date

FOR THE DEPARTMENT OF THE AIR FORCE:

MORIARTY.ROBE Digitally signed by
MORIARTY.ROBERT.E.101326758
RT.E.1013267584 4
Date: 2020.09.28 10:20:55 -04'00'

ROBERT E. MORIARTY, P.E.
Deputy Assistant Secretary of the Air Force
(Installations)

Date

FOR SPRINGFIELD WIND FARM LLC:

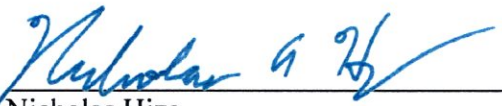

Nicholas Hiza
Vice President

9/1/2020

Date

ATTACHMENT A

**Federal Aviation Administration Filings for Springfield Wind Project
(2019-WTW-3918-OE thru 4197-OE)**

ASN	City	State	Structure Type	Feet AGL	Latitude (N)	Longitude (W)
2019-WTW-3918-OE	Springfield	CO	Wind Turbine	660	37.375	-102.961
2019-WTW-3919-OE	Springfield	CO	Wind Turbine	660	37.376	-102.772
2019-WTW-3920-OE	Springfield	CO	Wind Turbine	660	37.387	-102.951
2019-WTW-3921-OE	Springfield	CO	Wind Turbine	660	37.375	-102.781
2019-WTW-3922-OE	Springfield	CO	Wind Turbine	660	37.374	-102.703
2019-WTW-3923-OE	Springfield	CO	Wind Turbine	660	37.372	-102.951
2019-WTW-3924-OE	Springfield	CO	Wind Turbine	660	37.372	-102.944
2019-WTW-3925-OE	Springfield	CO	Wind Turbine	660	37.373	-102.689
2019-WTW-3926-OE	Springfield	CO	Wind Turbine	660	37.373	-102.929
2019-WTW-3927-OE	Springfield	CO	Wind Turbine	660	37.356	-102.789
2019-WTW-3928-OE	Springfield	CO	Wind Turbine	660	37.417	-102.928
2019-WTW-3929-OE	Springfield	CO	Wind Turbine	660	37.360	-102.794
2019-WTW-3930-OE	Springfield	CO	Wind Turbine	660	37.374	-102.795
2019-WTW-3931-OE	Springfield	CO	Wind Turbine	660	37.372	-102.936
2019-WTW-3932-OE	Springfield	CO	Wind Turbine	660	37.371	-102.695
2019-WTW-3933-OE	Springfield	CO	Wind Turbine	660	37.371	-102.849
2019-WTW-3934-OE	Springfield	CO	Wind Turbine	660	37.369	-102.732
2019-WTW-3935-OE	Springfield	CO	Wind Turbine	660	37.373	-102.915
2019-WTW-3936-OE	Springfield	CO	Wind Turbine	660	37.372	-102.922
2019-WTW-3937-OE	Springfield	CO	Wind Turbine	660	37.367	-102.714
2019-WTW-3938-OE	Springfield	CO	Wind Turbine	660	37.401	-102.659
2019-WTW-3939-OE	Springfield	CO	Wind Turbine	660	37.367	-102.727
2019-WTW-3940-OE	Springfield	CO	Wind Turbine	660	37.367	-102.739
2019-WTW-3941-OE	Springfield	CO	Wind Turbine	660	37.409	-102.683
2019-WTW-3942-OE	Springfield	CO	Wind Turbine	660	37.372	-102.842
2019-WTW-3943-OE	Springfield	CO	Wind Turbine	660	37.367	-102.720
2019-WTW-3944-OE	Springfield	CO	Wind Turbine	660	37.373	-102.879
2019-WTW-3945-OE	Springfield	CO	Wind Turbine	660	37.368	-102.836
2019-WTW-3946-OE	Springfield	CO	Wind Turbine	660	37.389	-102.943
2019-WTW-3947-OE	Springfield	CO	Wind Turbine	660	37.365	-102.821
2019-WTW-3948-OE	Springfield	CO	Wind Turbine	660	37.495	-102.854
2019-WTW-3949-OE	Springfield	CO	Wind Turbine	660	37.364	-102.826
2019-WTW-3950-OE	Springfield	CO	Wind Turbine	660	37.471	-102.878
2019-WTW-3951-OE	Springfield	CO	Wind Turbine	660	37.364	-102.832

ASN	City	State	Structure Type	Feet AGL	Latitude (N)	Longitude (W)
2019-WTW-3952-OE	Springfield	CO	Wind Turbine	660	37.372	-102.872
2019-WTW-3953-OE	Springfield	CO	Wind Turbine	660	37.390	-102.917
2019-WTW-3954-OE	Springfield	CO	Wind Turbine	660	37.360	-102.817
2019-WTW-3955-OE	Springfield	CO	Wind Turbine	660	37.397	-102.864
2019-WTW-3956-OE	Springfield	CO	Wind Turbine	660	37.358	-102.812
2019-WTW-3957-OE	Springfield	CO	Wind Turbine	660	37.361	-102.958
2019-WTW-3958-OE	Springfield	CO	Wind Turbine	660	37.429	-102.672
2019-WTW-3959-OE	Springfield	CO	Wind Turbine	660	37.355	-102.699
2019-WTW-3960-OE	Springfield	CO	Wind Turbine	660	37.398	-102.675
2019-WTW-3961-OE	Springfield	CO	Wind Turbine	660	37.355	-102.713
2019-WTW-3962-OE	Springfield	CO	Wind Turbine	660	37.356	-102.807
2019-WTW-3963-OE	Springfield	CO	Wind Turbine	660	37.403	-102.699
2019-WTW-3964-OE	Springfield	CO	Wind Turbine	660	37.403	-102.942
2019-WTW-3965-OE	Springfield	CO	Wind Turbine	660	37.354	-102.689
2019-WTW-3966-OE	Springfield	CO	Wind Turbine	660	37.354	-102.767
2019-WTW-3967-OE	Springfield	CO	Wind Turbine	660	37.354	-102.707
2019-WTW-3968-OE	Springfield	CO	Wind Turbine	660	37.387	-102.818
2019-WTW-3969-OE	Springfield	CO	Wind Turbine	660	37.441	-102.830
2019-WTW-3970-OE	Springfield	CO	Wind Turbine	660	37.432	-102.657
2019-WTW-3971-OE	Springfield	CO	Wind Turbine	660	37.400	-102.713
2019-WTW-3972-OE	Springfield	CO	Wind Turbine	660	37.351	-102.645
2019-WTW-3973-OE	Springfield	CO	Wind Turbine	660	37.353	-102.762
2019-WTW-3974-OE	Springfield	CO	Wind Turbine	660	37.374	-102.909
2019-WTW-3975-OE	Springfield	CO	Wind Turbine	660	37.407	-102.689
2019-WTW-3976-OE	Springfield	CO	Wind Turbine	660	37.395	-102.739
2019-WTW-3977-OE	Springfield	CO	Wind Turbine	660	37.353	-102.773
2019-WTW-3978-OE	Springfield	CO	Wind Turbine	660	37.417	-102.922
2019-WTW-3979-OE	Springfield	CO	Wind Turbine	660	37.356	-102.954
2019-WTW-3980-OE	Springfield	CO	Wind Turbine	660	37.355	-102.926
2019-WTW-3981-OE	Springfield	CO	Wind Turbine	660	37.387	-102.924
2019-WTW-3982-OE	Springfield	CO	Wind Turbine	660	37.354	-102.949
2019-WTW-3983-OE	Springfield	CO	Wind Turbine	660	37.390	-102.763
2019-WTW-3984-OE	Springfield	CO	Wind Turbine	660	37.353	-102.944
2019-WTW-3985-OE	Springfield	CO	Wind Turbine	660	37.344	-102.642
2019-WTW-3986-OE	Springfield	CO	Wind Turbine	660	37.350	-102.908
2019-WTW-3987-OE	Springfield	CO	Wind Turbine	660	37.398	-102.727
2019-WTW-3988-OE	Springfield	CO	Wind Turbine	660	37.350	-102.880
2019-WTW-3989-OE	Springfield	CO	Wind Turbine	660	37.396	-102.804

ASN	City	State	Structure Type	Feet AGL	Latitude (N)	Longitude (W)
2019-WTW-3990-OE	Springfield	CO	Wind Turbine	660	37.394	-102.899
2019-WTW-3991-OE	Springfield	CO	Wind Turbine	660	37.349	-102.843
2019-WTW-3992-OE	Springfield	CO	Wind Turbine	660	37.350	-102.885
2019-WTW-3993-OE	Springfield	CO	Wind Turbine	660	37.430	-102.664
2019-WTW-3994-OE	Springfield	CO	Wind Turbine	660	37.400	-102.720
2019-WTW-3995-OE	Springfield	CO	Wind Turbine	660	37.345	-102.807
2019-WTW-3996-OE	Springfield	CO	Wind Turbine	660	37.349	-102.874
2019-WTW-3997-OE	Springfield	CO	Wind Turbine	660	37.349	-102.866
2019-WTW-3998-OE	Springfield	CO	Wind Turbine	660	37.349	-102.849
2019-WTW-3999-OE	Springfield	CO	Wind Turbine	660	37.348	-102.855
2019-WTW-4000-OE	Springfield	CO	Wind Turbine	660	37.422	-102.733
2019-WTW-4001-OE	Springfield	CO	Wind Turbine	660	37.340	-102.791
2019-WTW-4002-OE	Springfield	CO	Wind Turbine	660	37.401	-102.706
2019-WTW-4003-OE	Springfield	CO	Wind Turbine	660	37.350	-102.914
2019-WTW-4004-OE	Springfield	CO	Wind Turbine	660	37.350	-102.920
2019-WTW-4005-OE	Springfield	CO	Wind Turbine	660	37.373	-102.894
2019-WTW-4006-OE	Springfield	CO	Wind Turbine	660	37.396	-102.852
2019-WTW-4007-OE	Springfield	CO	Wind Turbine	660	37.375	-102.902
2019-WTW-4008-OE	Springfield	CO	Wind Turbine	660	37.375	-102.887
2019-WTW-4009-OE	Springfield	CO	Wind Turbine	660	37.340	-102.727
2019-WTW-4010-OE	Springfield	CO	Wind Turbine	660	37.392	-102.908
2019-WTW-4011-OE	Springfield	CO	Wind Turbine	660	37.349	-102.636
2019-WTW-4012-OE	Springfield	CO	Wind Turbine	660	37.341	-102.634
2019-WTW-4013-OE	Springfield	CO	Wind Turbine	660	37.428	-102.872
2019-WTW-4014-OE	Springfield	CO	Wind Turbine	660	37.343	-102.895
2019-WTW-4015-OE	Springfield	CO	Wind Turbine	660	37.348	-102.861
2019-WTW-4016-OE	Springfield	CO	Wind Turbine	660	37.418	-102.909
2019-WTW-4017-OE	Springfield	CO	Wind Turbine	660	37.336	-102.735
2019-WTW-4018-OE	Springfield	CO	Wind Turbine	660	37.473	-102.866
2019-WTW-4019-OE	Springfield	CO	Wind Turbine	660	37.336	-102.630
2019-WTW-4020-OE	Springfield	CO	Wind Turbine	660	37.339	-102.722
2019-WTW-4021-OE	Springfield	CO	Wind Turbine	660	37.389	-102.811
2019-WTW-4022-OE	Springfield	CO	Wind Turbine	660	37.392	-102.875
2019-WTW-4023-OE	Springfield	CO	Wind Turbine	660	37.390	-102.935
2019-WTW-4024-OE	Springfield	CO	Wind Turbine	660	37.418	-102.915
2019-WTW-4025-OE	Springfield	CO	Wind Turbine	660	37.392	-102.751
2019-WTW-4026-OE	Springfield	CO	Wind Turbine	660	37.342	-102.831
2019-WTW-4027-OE	Springfield	CO	Wind Turbine	660	37.423	-102.889

ASN	City	State	Structure Type	Feet AGL	Latitude (N)	Longitude (W)
2019-WTW-4028-OE	Springfield	CO	Wind Turbine	660	37.338	-102.745
2019-WTW-4029-OE	Springfield	CO	Wind Turbine	660	37.338	-102.671
2019-WTW-4030-OE	Springfield	CO	Wind Turbine	660	37.338	-102.694
2019-WTW-4031-OE	Springfield	CO	Wind Turbine	660	37.339	-102.708
2019-WTW-4032-OE	Springfield	CO	Wind Turbine	660	37.400	-102.667
2019-WTW-4033-OE	Springfield	CO	Wind Turbine	660	37.403	-102.778
2019-WTW-4034-OE	Springfield	CO	Wind Turbine	660	37.336	-102.716
2019-WTW-4035-OE	Springfield	CO	Wind Turbine	660	37.405	-102.771
2019-WTW-4036-OE	Springfield	CO	Wind Turbine	660	37.339	-102.624
2019-WTW-4037-OE	Springfield	CO	Wind Turbine	660	37.490	-102.840
2019-WTW-4038-OE	Springfield	CO	Wind Turbine	660	37.335	-102.704
2019-WTW-4039-OE	Springfield	CO	Wind Turbine	660	37.472	-102.872
2019-WTW-4040-OE	Springfield	CO	Wind Turbine	660	37.331	-102.621
2019-WTW-4041-OE	Springfield	CO	Wind Turbine	660	37.396	-102.733
2019-WTW-4042-OE	Springfield	CO	Wind Turbine	660	37.333	-102.679
2019-WTW-4043-OE	Springfield	CO	Wind Turbine	660	37.475	-102.807
2019-WTW-4044-OE	Springfield	CO	Wind Turbine	660	37.335	-102.975
2019-WTW-4045-OE	Springfield	CO	Wind Turbine	660	37.421	-102.895
2019-WTW-4046-OE	Springfield	CO	Wind Turbine	660	37.334	-102.958
2019-WTW-4047-OE	Springfield	CO	Wind Turbine	660	37.423	-102.790
2019-WTW-4048-OE	Springfield	CO	Wind Turbine	660	37.334	-102.964
2019-WTW-4049-OE	Springfield	CO	Wind Turbine	660	37.403	-102.935
2019-WTW-4050-OE	Springfield	CO	Wind Turbine	660	37.331	-102.841
2019-WTW-4051-OE	Springfield	CO	Wind Turbine	660	37.424	-102.880
2019-WTW-4052-OE	Springfield	CO	Wind Turbine	660	37.414	-102.760
2019-WTW-4053-OE	Springfield	CO	Wind Turbine	660	37.333	-102.952
2019-WTW-4054-OE	Springfield	CO	Wind Turbine	660	37.390	-102.888
2019-WTW-4055-OE	Springfield	CO	Wind Turbine	660	37.330	-102.830
2019-WTW-4056-OE	Springfield	CO	Wind Turbine	660	37.402	-102.785
2019-WTW-4057-OE	Springfield	CO	Wind Turbine	660	37.330	-102.824
2019-WTW-4058-OE	Springfield	CO	Wind Turbine	660	37.414	-102.750
2019-WTW-4059-OE	Springfield	CO	Wind Turbine	660	37.331	-102.863
2019-WTW-4060-OE	Springfield	CO	Wind Turbine	660	37.473	-102.859
2019-WTW-4061-OE	Springfield	CO	Wind Turbine	660	37.331	-102.894
2019-WTW-4062-OE	Springfield	CO	Wind Turbine	660	37.430	-102.865
2019-WTW-4063-OE	Springfield	CO	Wind Turbine	660	37.326	-102.689
2019-WTW-4064-OE	Springfield	CO	Wind Turbine	660	37.398	-102.798
2019-WTW-4065-OE	Springfield	CO	Wind Turbine	660	37.331	-102.946

ASN	City	State	Structure Type	Feet AGL	Latitude (N)	Longitude (W)
2019-WTW-4066-OE	Springfield	CO	Wind Turbine	660	37.418	-102.902
2019-WTW-4067-OE	Springfield	CO	Wind Turbine	660	37.328	-102.650
2019-WTW-4068-OE	Springfield	CO	Wind Turbine	660	37.331	-102.970
2019-WTW-4069-OE	Springfield	CO	Wind Turbine	660	37.425	-102.707
2019-WTW-4070-OE	Springfield	CO	Wind Turbine	660	37.391	-102.882
2019-WTW-4071-OE	Springfield	CO	Wind Turbine	660	37.329	-102.889
2019-WTW-4072-OE	Springfield	CO	Wind Turbine	660	37.456	-102.804
2019-WTW-4073-OE	Springfield	CO	Wind Turbine	660	37.329	-102.903
2019-WTW-4074-OE	Springfield	CO	Wind Turbine	660	37.493	-102.847
2019-WTW-4075-OE	Springfield	CO	Wind Turbine	660	37.324	-102.645
2019-WTW-4076-OE	Springfield	CO	Wind Turbine	660	37.492	-102.804
2019-WTW-4077-OE	Springfield	CO	Wind Turbine	660	37.328	-102.848
2019-WTW-4078-OE	Springfield	CO	Wind Turbine	660	37.486	-102.827
2019-WTW-4079-OE	Springfield	CO	Wind Turbine	660	37.324	-102.673
2019-WTW-4080-OE	Springfield	CO	Wind Turbine	660	37.440	-102.777
2019-WTW-4081-OE	Springfield	CO	Wind Turbine	660	37.324	-102.698
2019-WTW-4082-OE	Springfield	CO	Wind Turbine	660	37.425	-102.715
2019-WTW-4083-OE	Springfield	CO	Wind Turbine	660	37.326	-102.817
2019-WTW-4084-OE	Springfield	CO	Wind Turbine	660	37.437	-102.839
2019-WTW-4085-OE	Springfield	CO	Wind Turbine	660	37.327	-102.858
2019-WTW-4086-OE	Springfield	CO	Wind Turbine	660	37.488	-102.834
2019-WTW-4087-OE	Springfield	CO	Wind Turbine	660	37.322	-102.663
2019-WTW-4088-OE	Springfield	CO	Wind Turbine	660	37.441	-102.818
2019-WTW-4089-OE	Springfield	CO	Wind Turbine	660	37.327	-102.931
2019-WTW-4090-OE	Springfield	CO	Wind Turbine	660	37.325	-102.871
2019-WTW-4091-OE	Springfield	CO	Wind Turbine	660	37.391	-102.757
2019-WTW-4092-OE	Springfield	CO	Wind Turbine	660	37.324	-102.812
2019-WTW-4093-OE	Springfield	CO	Wind Turbine	660	37.442	-102.753
2019-WTW-4094-OE	Springfield	CO	Wind Turbine	660	37.319	-102.641
2019-WTW-4095-OE	Springfield	CO	Wind Turbine	660	37.458	-102.792
2019-WTW-4096-OE	Springfield	CO	Wind Turbine	660	37.325	-102.878
2019-WTW-4097-OE	Springfield	CO	Wind Turbine	660	37.472	-102.817
2019-WTW-4098-OE	Springfield	CO	Wind Turbine	660	37.472	-102.852
2019-WTW-4099-OE	Springfield	CO	Wind Turbine	660	37.321	-102.635
2019-WTW-4100-OE	Springfield	CO	Wind Turbine	660	37.395	-102.846
2019-WTW-4101-OE	Springfield	CO	Wind Turbine	660	37.325	-102.884
2019-WTW-4102-OE	Springfield	CO	Wind Turbine	660	37.395	-102.826
2019-WTW-4103-OE	Springfield	CO	Wind Turbine	660	37.319	-102.658

ASN	City	State	Structure Type	Feet AGL	Latitude (N)	Longitude (W)
2019-WTW-4104-OE	Springfield	CO	Wind Turbine	660	37.325	-102.910
2019-WTW-4105-OE	Springfield	CO	Wind Turbine	660	37.432	-102.853
2019-WTW-4106-OE	Springfield	CO	Wind Turbine	660	37.394	-102.833
2019-WTW-4107-OE	Springfield	CO	Wind Turbine	660	37.325	-102.916
2019-WTW-4108-OE	Springfield	CO	Wind Turbine	660	37.326	-103.012
2019-WTW-4109-OE	Springfield	CO	Wind Turbine	660	37.424	-102.725
2019-WTW-4110-OE	Springfield	CO	Wind Turbine	660	37.416	-102.863
2019-WTW-4111-OE	Springfield	CO	Wind Turbine	660	37.325	-102.926
2019-WTW-4112-OE	Springfield	CO	Wind Turbine	660	37.325	-102.937
2019-WTW-4113-OE	Springfield	CO	Wind Turbine	660	37.416	-102.853
2019-WTW-4114-OE	Springfield	CO	Wind Turbine	660	37.418	-102.832
2019-WTW-4115-OE	Springfield	CO	Wind Turbine	660	37.328	-103.006
2019-WTW-4116-OE	Springfield	CO	Wind Turbine	660	37.471	-102.844
2019-WTW-4117-OE	Springfield	CO	Wind Turbine	660	37.324	-102.994
2019-WTW-4118-OE	Springfield	CO	Wind Turbine	660	37.441	-102.809
2019-WTW-4119-OE	Springfield	CO	Wind Turbine	660	37.315	-102.631
2019-WTW-4120-OE	Springfield	CO	Wind Turbine	660	37.323	-102.989
2019-WTW-4121-OE	Springfield	CO	Wind Turbine	660	37.441	-102.799
2019-WTW-4122-OE	Springfield	CO	Wind Turbine	660	37.318	-102.808
2019-WTW-4123-OE	Springfield	CO	Wind Turbine	660	37.471	-102.837
2019-WTW-4124-OE	Springfield	CO	Wind Turbine	660	37.494	-102.810
2019-WTW-4125-OE	Springfield	CO	Wind Turbine	660	37.315	-102.626
2019-WTW-4126-OE	Springfield	CO	Wind Turbine	660	37.322	-103.002
2019-WTW-4127-OE	Springfield	CO	Wind Turbine	660	37.417	-102.839
2019-WTW-4128-OE	Springfield	CO	Wind Turbine	660	37.441	-102.770
2019-WTW-4129-OE	Springfield	CO	Wind Turbine	660	37.315	-102.708
2019-WTW-4130-OE	Springfield	CO	Wind Turbine	660	37.395	-102.839
2019-WTW-4131-OE	Springfield	CO	Wind Turbine	660	37.314	-102.621
2019-WTW-4132-OE	Springfield	CO	Wind Turbine	660	37.459	-102.780
2019-WTW-4133-OE	Springfield	CO	Wind Turbine	660	37.320	-102.985
2019-WTW-4134-OE	Springfield	CO	Wind Turbine	660	37.315	-102.759
2019-WTW-4135-OE	Springfield	CO	Wind Turbine	660	37.434	-102.846
2019-WTW-4136-OE	Springfield	CO	Wind Turbine	660	37.456	-102.772
2019-WTW-4137-OE	Springfield	CO	Wind Turbine	660	37.315	-102.786
2019-WTW-4138-OE	Springfield	CO	Wind Turbine	660	37.314	-102.804
2019-WTW-4139-OE	Springfield	CO	Wind Turbine	660	37.440	-102.761
2019-WTW-4140-OE	Springfield	CO	Wind Turbine	660	37.318	-102.980
2019-WTW-4141-OE	Springfield	CO	Wind Turbine	660	37.471	-102.826

ASN	City	State	Structure Type	Feet AGL	Latitude (N)	Longitude (W)
2019-WTW-4142-OE	Springfield	CO	Wind Turbine	660	37.313	-102.799
2019-WTW-4143-OE	Springfield	CO	Wind Turbine	660	37.441	-102.791
2019-WTW-4144-OE	Springfield	CO	Wind Turbine	660	37.419	-102.822
2019-WTW-4145-OE	Springfield	CO	Wind Turbine	660	37.314	-102.752
2019-WTW-4146-OE	Springfield	CO	Wind Turbine	660	37.413	-102.814
2019-WTW-4147-OE	Springfield	CO	Wind Turbine	660	37.312	-102.782
2019-WTW-4148-OE	Springfield	CO	Wind Turbine	660	37.315	-102.901
2019-WTW-4149-OE	Springfield	CO	Wind Turbine	660	37.311	-102.845
2019-WTW-4150-OE	Springfield	CO	Wind Turbine	660	37.311	-102.837
2019-WTW-4151-OE	Springfield	CO	Wind Turbine	660	37.309	-102.898
2019-WTW-4152-OE	Springfield	CO	Wind Turbine	660	37.312	-102.908
2019-WTW-4153-OE	Springfield	CO	Wind Turbine	660	37.312	-102.891
2019-WTW-4154-OE	Springfield	CO	Wind Turbine	660	37.303	-102.858
2019-WTW-4155-OE	Springfield	CO	Wind Turbine	660	37.306	-102.888
2019-WTW-4156-OE	Springfield	CO	Wind Turbine	660	37.302	-102.621
2019-WTW-4157-OE	Springfield	CO	Wind Turbine	660	37.308	-102.881
2019-WTW-4158-OE	Springfield	CO	Wind Turbine	660	37.305	-102.740
2019-WTW-4159-OE	Springfield	CO	Wind Turbine	660	37.305	-102.876
2019-WTW-4160-OE	Springfield	CO	Wind Turbine	660	37.302	-102.733
2019-WTW-4161-OE	Springfield	CO	Wind Turbine	660	37.301	-102.727
2019-WTW-4162-OE	Springfield	CO	Wind Turbine	660	37.307	-102.869
2019-WTW-4163-OE	Springfield	CO	Wind Turbine	660	37.302	-102.704
2019-WTW-4164-OE	Springfield	CO	Wind Turbine	660	37.307	-102.862
2019-WTW-4165-OE	Springfield	CO	Wind Turbine	660	37.306	-102.971
2019-WTW-4166-OE	Springfield	CO	Wind Turbine	660	37.302	-102.823
2019-WTW-4167-OE	Springfield	CO	Wind Turbine	660	37.302	-102.816
2019-WTW-4168-OE	Springfield	CO	Wind Turbine	660	37.302	-102.829
2019-WTW-4169-OE	Springfield	CO	Wind Turbine	660	37.304	-102.958
2019-WTW-4170-OE	Springfield	CO	Wind Turbine	660	37.301	-102.768
2019-WTW-4171-OE	Springfield	CO	Wind Turbine	660	37.301	-102.835
2019-WTW-4172-OE	Springfield	CO	Wind Turbine	660	37.303	-102.939
2019-WTW-4173-OE	Springfield	CO	Wind Turbine	660	37.302	-102.953
2019-WTW-4174-OE	Springfield	CO	Wind Turbine	660	37.297	-102.761
2019-WTW-4175-OE	Springfield	CO	Wind Turbine	660	37.301	-102.947
2019-WTW-4176-OE	Springfield	CO	Wind Turbine	660	37.296	-102.670
2019-WTW-4177-OE	Springfield	CO	Wind Turbine	660	37.296	-102.776
2019-WTW-4178-OE	Springfield	CO	Wind Turbine	660	37.298	-102.934
2019-WTW-4179-OE	Springfield	CO	Wind Turbine	660	37.297	-102.929

ASN	City	State	Structure Type	Feet AGL	Latitude (N)	Longitude (W)
2019-WTW-4180-OE	Springfield	CO	Wind Turbine	660	37.296	-102.924
2019-WTW-4181-OE	Springfield	CO	Wind Turbine	660	37.288	-102.685
2019-WTW-4182-OE	Springfield	CO	Wind Turbine	660	37.292	-102.885
2019-WTW-4183-OE	Springfield	CO	Wind Turbine	660	37.292	-102.992
2019-WTW-4184-OE	Springfield	CO	Wind Turbine	660	37.292	-102.986
2019-WTW-4185-OE	Springfield	CO	Wind Turbine	660	37.284	-102.679
2019-WTW-4186-OE	Springfield	CO	Wind Turbine	660	37.287	-102.881
2019-WTW-4187-OE	Springfield	CO	Wind Turbine	660	37.289	-102.898
2019-WTW-4188-OE	Springfield	CO	Wind Turbine	660	37.286	-102.848
2019-WTW-4189-OE	Springfield	CO	Wind Turbine	660	37.286	-102.864
2019-WTW-4190-OE	Springfield	CO	Wind Turbine	660	37.285	-102.858
2019-WTW-4191-OE	Springfield	CO	Wind Turbine	660	37.287	-102.922
2019-WTW-4192-OE	Springfield	CO	Wind Turbine	660	37.284	-102.876
2019-WTW-4193-OE	Springfield	CO	Wind Turbine	660	37.285	-102.917
2019-WTW-4194-OE	Springfield	CO	Wind Turbine	660	37.285	-102.871
2019-WTW-4195-OE	Springfield	CO	Wind Turbine	660	37.283	-102.911
2019-WTW-4196-OE	Springfield	CO	Wind Turbine	660	37.284	-102.979
2019-WTW-4197-OE	Springfield	CO	Wind Turbine	660	37.281	-102.985
To Be Filed	Springfield	CO	MET Tower	TBD	TBD	TBD
To Be Filed	Springfield	CO	MET Tower	TBD	TBD	TBD
To Be Filed	Springfield	CO	MET Tower	TBD	TBD	TBD
To Be Filed	Springfield	CO	MET Tower	TBD	TBD	TBD
To Be Filed	Springfield	CO	MET Tower	TBD	TBD	TBD

ATTACHMENT B
Springfield Wind Turbines and Project Area

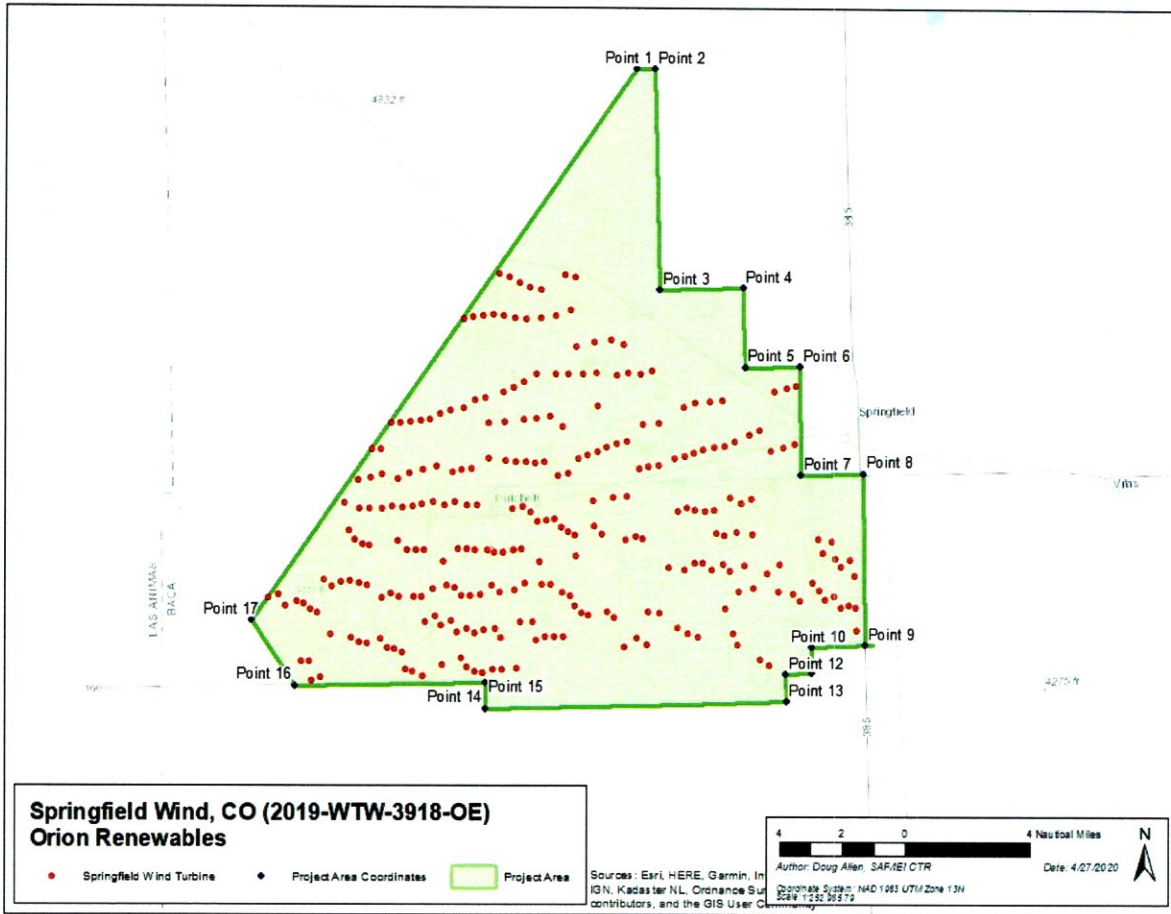

ATTACHMENT C
Springfield Wind Project Area Coordinates

Point	Latitude	Longitude	Notes
1	37.6016899 N	-102.759759 W	
2	37.60154837 N	-102.7476068 W	
3	37.48419028 N	-102.747221 W	
4	37.4843718 N	-102.691597 W	
5	37.44262285 N	-102.6914747 W	
6	37.44198146 N	-102.6546347 W	
7	37.384587 N	-102.6558566 W	
8	37.38473313 N	-102.6139747 W	
9	37.2937854 N	-102.6157272 W	
10	37.29335717 N	-102.6515008 W	
11	37.27946505 N	-102.6517072 W	
12	37.27928801 N	-102.6688488 W	
13	37.26478915 N	-102.6689858 W	
14	37.26475767 N	-102.8694562 W	
15	37.27863401 N	-102.8690818 W	
16	37.27904304 N	-102.9960766 W	
17	37.31407714 N	-103.0243878 W	Reconnecting to Point 1